

# KEL-U 10

## Cable Entry Frames



Slit grommets



V2A  
anti-corrosive

Also available with stainless steel screws (V2A).



Also available with threaded bushings.

1



Description	Type	Order No.	Grommets small   large	PU
-------------	------	-----------	---------------------------	----

### Product Description

Split cable entry system for routing cables with connectors, providing an IP54 / up to NEMA type 12 rating. Routing, sealing and providing strain relief for cable diameters from 2 to 35 mm. The new cable entry system is easy to install. Cable grommets are placed into compartments in the frame and are securely fixed to the frame during assembly. The KEL-U 10 frame matches exactly the cut-out dimensions for 10-pin standard industrial connectors. Either a cut-out of 36 mm or 46 mm in height can be chosen depending on the cables being routed. A flat rubber gasket is included in the shipment.

### Advantages & Benefits

- Fast and easy assembly
- Warranty on pre-terminated cables remains
- Retrofits, repairs and maintenance can be done much more easily and quickly
- High cable density, wide variety of grommets
- Strain relief according to EN 62444
- High stability, vibration resistant

### Specifications

Material	Polyamide (PA)
Flame class	UL94-V0
IP rating	IP54, with gasket and correct selection of cable grommets (certified acc. to EN 60529)
NEMA type rating	NEMA type 12 (acc. to UL 50E)
Temperature	- 40°C to + 140°C (static) - 40°F to + 284°F (static)
Properties	Halogen-free, silicone-free
Cut-out dimensions	36/46 × 65 mm / Page 192 - 193
Frame depth	17 mm

### Accessories

Cable grommets	44 - 48
KEL-SNAP Mounting frames	36 - 37
KEL-EMC Grounding mounts	122 - 124

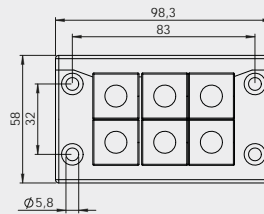

KEL-U 10|6

54216

6|-

10

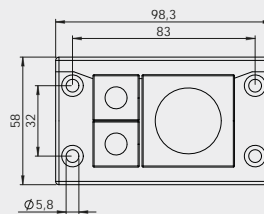

KEL-U 10|3

54212

2|1

10

KEL-U 10|3  
with V2A screws

54212.200

2|1

10